

Boston home

44
AWARD
WINNERS
INSIDE

BEST OF *Boston Home*

THE ULTIMATE RENOVATION GUIDE, FEATURING
DESIGNERS, BUILDERS, SHOPS, AND MORE

A Lynnfield living
area designed
by winner Ana
Donohue.
See page 64.

PLUS

**BACK BAY
BEAUTY**

A FRESH TAKE ON A
HISTORICAL CONDO

ESSENTIALS

- 19 EDITORS' PICKS**
Settle in this winter with enticing home accessories.
- 26 READING LIST**
A celebration of Black artists, award-winning architecture, and sustainable décor.
- 28 PALETTES**
Three local interior design teams curate mood boards for trendy mudrooms.

INNOVATORS

- 35 RENOVATION**
Designer Jill Najnigier transforms a Southie studio into a one-bedroom bachelor pad with contemporary flair.
- 40 OBSESSIONS**
Jadine Greenaway and Sheila Galligan of Dove and Donkey, and Tardy Donkey, share some of their favorite things.
- 42 SPACES**
Eleven Interiors brings a mix of materials—and a whole lot of character—to a Dedham living room.
- 44 Q & A**
Dream Collaborative cofounder Greg Minott talks fostering diversity in local design.

IN EVERY ISSUE

- 12 FROM THE EDITOR**
- 14 DESIGNER SPOTLIGHT**
Meet the winners of our 2021 Rising Star Awards.
- 82 RESOURCES**
- 87 STOCKIST**
- 112 HEADING HOME**
Interior designer Vani Sayeed reveals the revamped living room in her beloved Dutch Colonial.

19



26



35



40



COURTESY OF ESTELLE COLORED GLASS (19); NINA GALLANT (26); KEITARO YOSHIOKA (35); ALI CAMPBELL (40)

Innovators

RENOVATION • OBSESSIONS • SPACES • Q&A



RENOVATION

SETTING BOUNDARIES

*Designer Jill Najnigier transforms
a Southie studio into a one-bedroom bachelor
pad with contemporary flair.*

BY MARNI ELYSE KATZ
PHOTOGRAPHS BY KEITARO YOSHIOKA

JILL NAJNIGIER'S CLIENT

wanted another wall. While he loved the views and open plan of his South Boston studio, located just a few blocks from the beach, he wasn't keen on one-room living. "Space planning was a big piece of this renovation," the designer says. "He really wanted a separate bedroom." He also wanted to maintain the unit's expansive feel—not an easy undertaking, given that it clocks in at 700 square feet. Luckily, the 12-foot ceilings helped, as did the client's contemporary tastes. "[We] kept everything clean," Najnigier explains. "Nothing chops up the space."

SET THE SCENE

Najnigier's first (and most important) task? Defining distinct areas. She created a bedroom by shortening a wall that jutted into the main space and adding another wall perpendicular to it. That left enough square footage for a living area, a kitchen, and a dining space with a table that feel separate, yet connected. "He wanted [guests] to be able to sit and eat, and still be part of the group," Najnigier says of the client's wish for the dining area. There are city and harbor views from that corner, and the high-top table lends a festive vibe.

CREATE A KILLER KITCHEN

Samantha DeMarco of Divine Design Center collaborated with Najnigier on the sleek kitchen: the home's focal point. "The eye is drawn right to the two [kitchen] windows when you walk in," Najnigier says. Calling on Leicht cabinetry, the pair developed a scheme that hides the appliances and incorporates storage in a new waterfall-edge peninsula, which offers seating for three. To dress up the space, Najnigier skipped the hardware, relying instead on open shelves, sculptural counter stools, and a minimalist suspension light.

UNIFY USING FINISHES

Knowing the unit's overall effect would be spare, Najnigier used wood tones throughout the home to warm and connect the spaces. Taking cues from the European white-oak floors, the designer mixed matte-gray kitchen cabinetry with panels in a rough-sawn oak finish, installed with the grain running both vertically and horizontally. In the living and dining areas, meanwhile, Najnigier turned to rich walnut accents, as well as touches of burnished brass. "I don't like everything to match," she says.



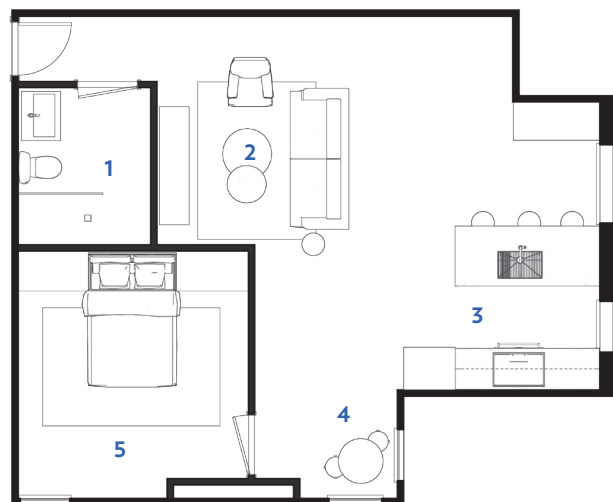

SPLURGE ON STORAGE

Although the unit had nary a closet, Najnigier resisted building any; she felt the doors and trim would disrupt the smooth flow of the space. Instead, she counseled the client to devote a chunk of the budget to creative, custom storage solutions—including a wall of built-in cabinetry, crafted by Scavolini, in the bedroom. It houses all of the client's clothing and boasts an integrated nightstand. "The piece feels very tailored and modern," Najnigier says.

BLOW OUT THE BATH

The homeowner also charged Najnigier with expanding the unit's only bathroom. During demolition, the team discovered unused space behind the existing bath wall, usurping it to increase the size of the walk-in shower. The client agreed to go curb-less despite the cost, creating an uninterrupted expanse of marble mosaic tile on the floor. "It makes the [room] seem so much larger," Najnigier says.

- 1 BATHROOM
- 2 LIVING AREA
- 3 KITCHEN
- 4 DINING AREA
- 5 BEDROOM

CONTRACTOR

ASPEN CONSULTING

INTERIOR DESIGNER

JN INTERIOR SPACES

KITCHEN INSTALLER

DIVINE DESIGN CENTER

TILE INSTALLER

INSTALLATIONS PLUS